

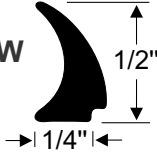

Window Edge Instructions

COMMON WINDOW
EDGE PROFILE



Steele Rubber Products has designed this window edge seal to last longer, be more durable, and effectively resist the impact of UV and ozone exposure. Once installed, no additional 'treatments' are necessary to further preserve your new window edge seal. Steele Rubber Products recommends simply keeping it clean and free of soil or debris.



Do your RV windows look like this?

Unlike the original window edge trim, Steele Rubber Products highly weather resistant rubber compound will not shrink and crack over time - remaining securely in place in the corners of the window frame.



EASY INSTALLATION - JUST PRESSES INTO TRACK

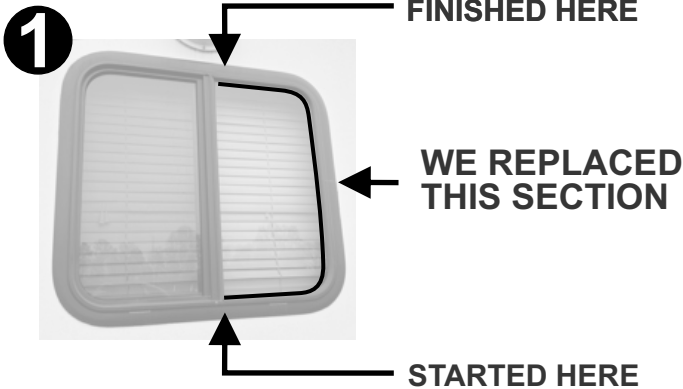

We replaced the window edge seal on a sliding window (shown above). Some RV windows are just a single piece of glass with no divider. The technique is the same either way.



Remove the old window edge trim by gently pulling it out of the window frame track. If an adhesive or caulking has been used, take care to remove this as well and clean the track thoroughly.

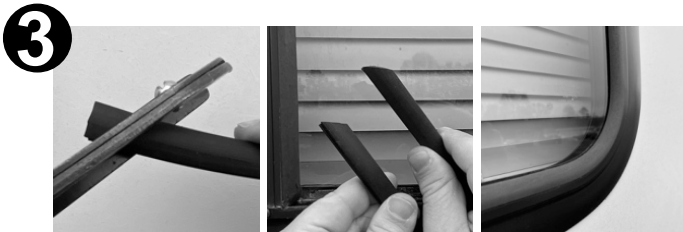

Be sure to cut the end of the new seal to match the angle of the old one. (either 45° or 90°) Begin pressing the new seal into the clean track and work your way around the window.



When you get to the end, trim the excess rubber and butt the end of the Edge Trim to fit. The new EPDM seal is now in place and will last for years to come.